

STACEY DEVELOPMENTS - UNIT FLOOR PLAN - 1C

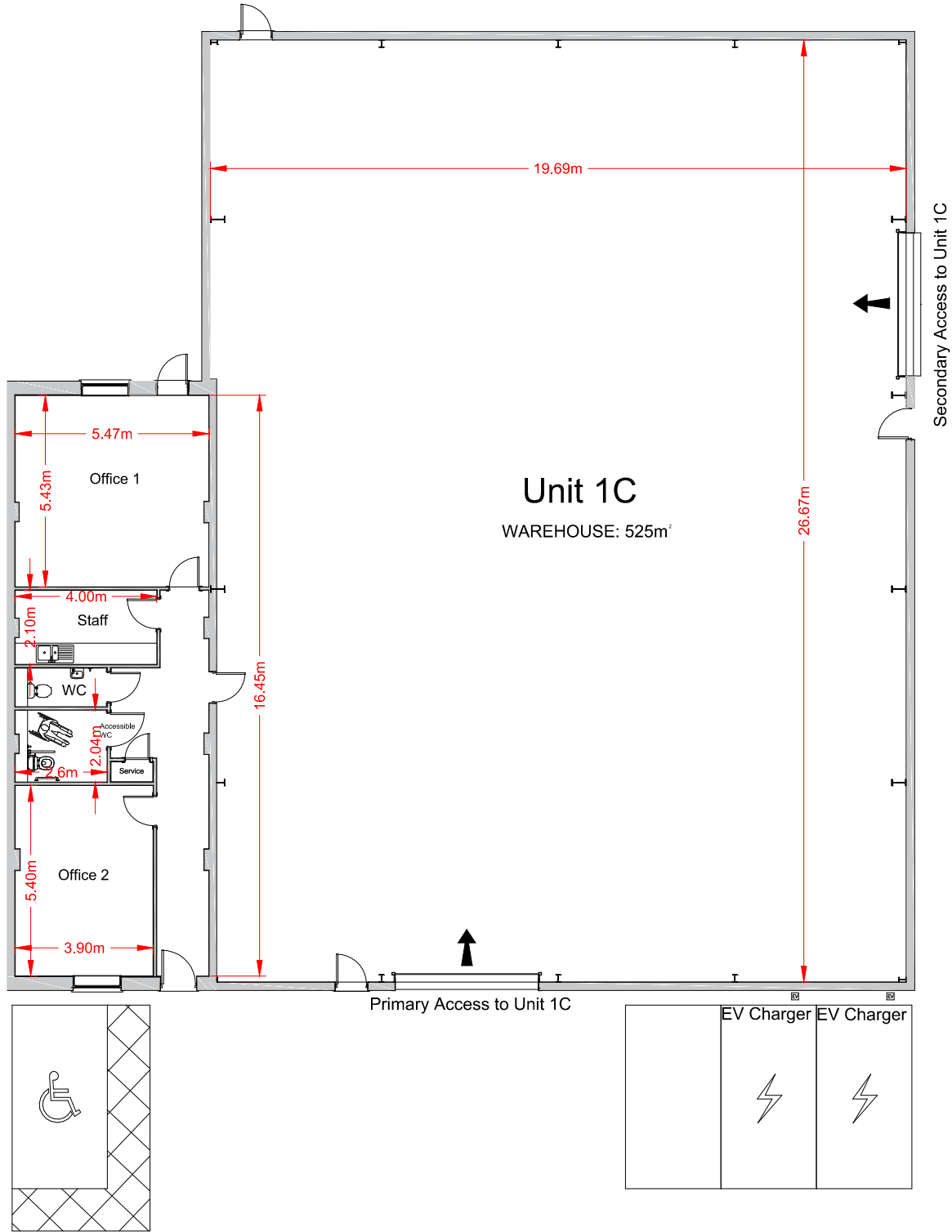

Unit Size

Unit 1C, Stacey's Industrian Yard, Tadley, Hampshire, RG26 3PZ		
Office 1	5.47m x 5.43m	29.7 m ² (320 ft ²)
Office 2	5.40m x 3.90m	21.1 m ² (227 ft ²)
Warehouse	26.67m x 19.69m	525 m ² (5651ft ²)
1st Floor	16.45m x 5.47m	90 m ² (969 ft ²)
	Overall Unit (excluding 1st Floor)	615 m ² (6620 ft ²)

Key Features of Unit 1C.

- 3Nr Solar Panels
- 2Nr EV Charging Points
- 3 Phase Electric Supply (112KV_a)
- Half Hourly Electric Metre
- EPC Rating A
- 2Nr Roller Shutter Door Access - 4m High and 4.05m Wide
- Wide Ranging Site CCTV, including ANPR Camera
- Phone Lines & Internet Connection
- DDA Compliant
- Fitted Kitchen

